

FOR SALE

~1 TO 2 ACRES OF FEE SIMPLE LAND



2 fee simple lots on South Kihei Road, next to McDonald's, that can be purchased separately or together.

- Both lots will share a single access from South Kihei Road. If the lots are purchased separately an easement will be granted to ensure both lots have access.
- A wetlands parcel (TMK: (2) 3-9-2-101) is included with the property. If purchased separately lots 1 and 2 will own a pro rata share.

Lot 1

- B-2 zoned
- 1204 S. Kihei Rd.
- TMK: 2-3-9-8:16
- \$2,000,000

Lot 2

- Zoned residential but community planned for business
- 13 & 23 Nohokai St. and 1194 & 1188 S. Kihei Rd.
- TMK: 2-3-9-7:37-40
- \$1,600,000

**FOR INFORMATION,
PLEASE CALL:**

Mario Cardone

PB, CardOneRealty Corp., subagent

891-8469

mario@peake-levoy.com

MauiCommercialProperties.com

The information contained herein comes from sources deemed reliable, but no warranties and guarantees as to the accuracy of the information should be construed. This information may be changed or this property withdrawn at any time without prior notice. No sub-agency is offered to cooperating Brokers.

Concept Site Plan

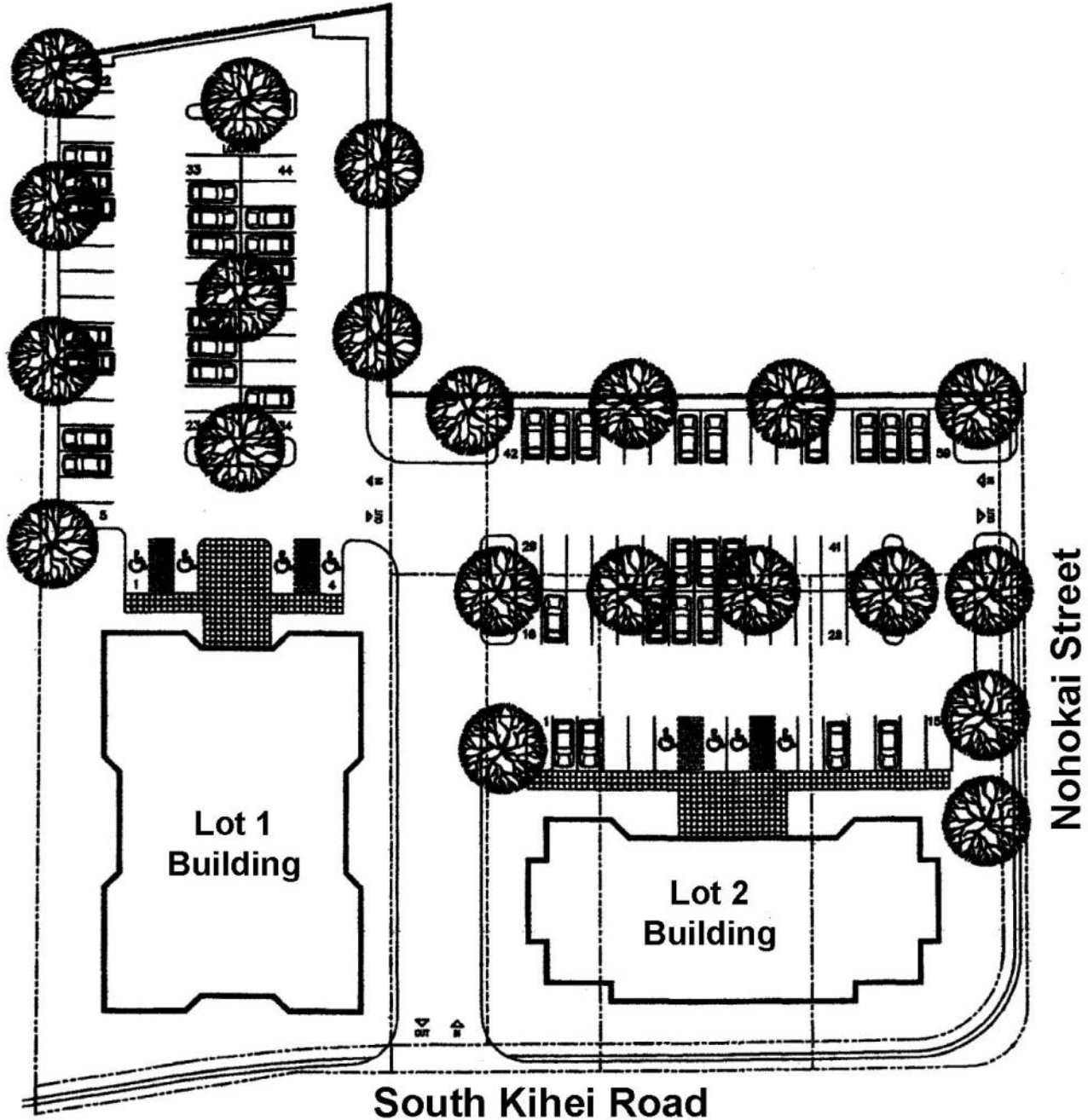

The information contained herein comes from sources deemed reliable, but no warranties and guarantees as to the accuracy of the information should be construed. This information may be changed or this property withdrawn at any time without prior notice. No sub-agency is offered to cooperating Brokers.